



# Installation Instruction

## T8 8FT Type B LED TUBE



PLEASE READ BEFORE USE!

### MARKINGS/WARNING:

- Please keep this guide for future reference.
- Risk of fire or electric shock. LED Retrofit Kit installation requires knowledge of luminaires electrical systems. If not qualified, do not attempt installation. Contact a qualified electrician.
- Risk of fire or electric shock. Install this kit only in the luminaires that have the construction features and dimensions shown in the photographs and/or drawings and where the input rating of the retrofit kit does not exceed the input rating of the luminaire.
- Do not make or alter any open holes in an enclosure of wiring or electrical components during kit installation
- To prevent wiring damage or abrasion, do not expose wiring to edges of sheet metal or other sharp objects.
- To avoid potential fire or shock hazard, do not use this retrofit kit in luminaires employing shunted bi-pin lamp holders. Note: Shunted lamp holders are found only in fluorescent luminaires with Instant-Start ballasts. Instant-start ballasts can be identified by the words "Instant Start" or "I.S." marked on the ballast. This designation may be in the form of a statement pertaining to the ballast itself, or may be combined with the marking for the lamps with which the ballast is intended to be used, for example F40T12/IS. For more information, contact the LED luminaire retrofit kit manufacturer.
- Installers should not disconnect existing wires from lamp holder terminals to make new connections at lamp holder terminals. Instead installers should cut existing lamp holder leads away from the lamp holder and make new electrical connections to lamp holder lead wires by employing applicable connectors.
- For a linear tubular LED lamp conversion, there shall be text or a diagram showing how the supply connections were made to the lamp holders so the correct connections will be made to the lamp when the lamp is installed or replaced.
- This retrofit kit is accepted as a component of a luminaire where the suitability of the combination shall be determined by authorities having JURISDICTION.
- If the tube is installed as Type B, the luminaire, once modified as retrofit fixture, will no longer operate fluorescent lamps.
- Dimmable with 0-10V dimming system\*- Dimming Module+0-10V/1-10V dimming switch.

### Structure

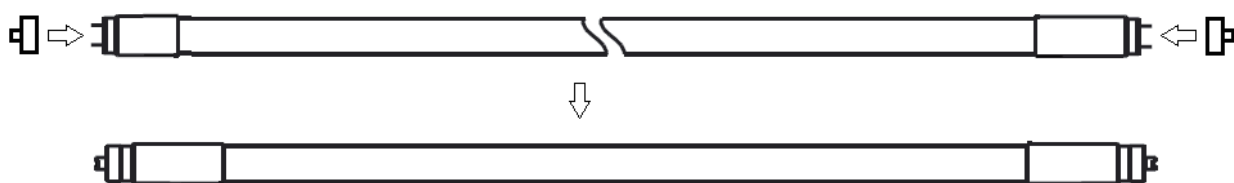

### Type B Installation introduction:

- DISCONNECT POWER OF LUMINAIRE.**  
Disconnect power to luminaire or circuit (if possible). Ensure all power is off by using a voltmeter or other method to confirm.
- REMOVE EXISTING TUBE LAMP(S)**

- Remove troffer lens, if present.
- Remove existing fluorescent as below.

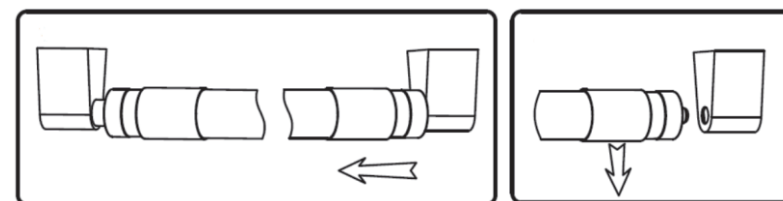

- Remove ballast cover. (Cover may be secured with screws or tabs).

### 3. REWIRE THE FIXTURE

- Disconnect the wires between starter and ballast.
- Connect two wires to branch circuit L and N according to the below figure.

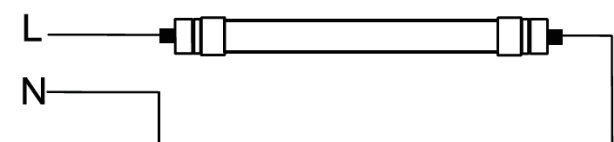

Double Ended Input(Type B)

Input voltage:120-277Vac 50/60HZ

### 4. INSERT LED TUBES

- Insert LED lamp in the normal way by sliding pins into sockets until LED tube locks in place as below.

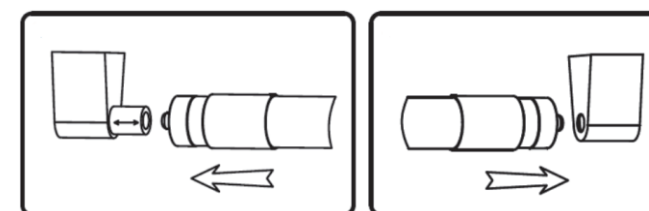

- Clip the anti-rotating clip on the middle of the tube and make sure the magnet is attached to the fixture to prevent tube droop and rotation
- LED lamps are now fully installed.
- Replace troffer lens, if present.
- After modification completed. Attach the Replacement Marking and cautionary Label to a visible place on the luminaire and keep it visible after installation.

### 5. RESTORE THE POWER OF LUMINAIRE

Restore power to circuit/luminaire and test light. If necessary, adjust position of LED tube, and enjoy your new LED tube light!